

LOC		DIST		REVISIONS			
P	LR	DESCRIPTION	DATE	BY	APPD		
0		REVISE PER ECN 0U1B-0210-00	27NOV00	SU	DK		

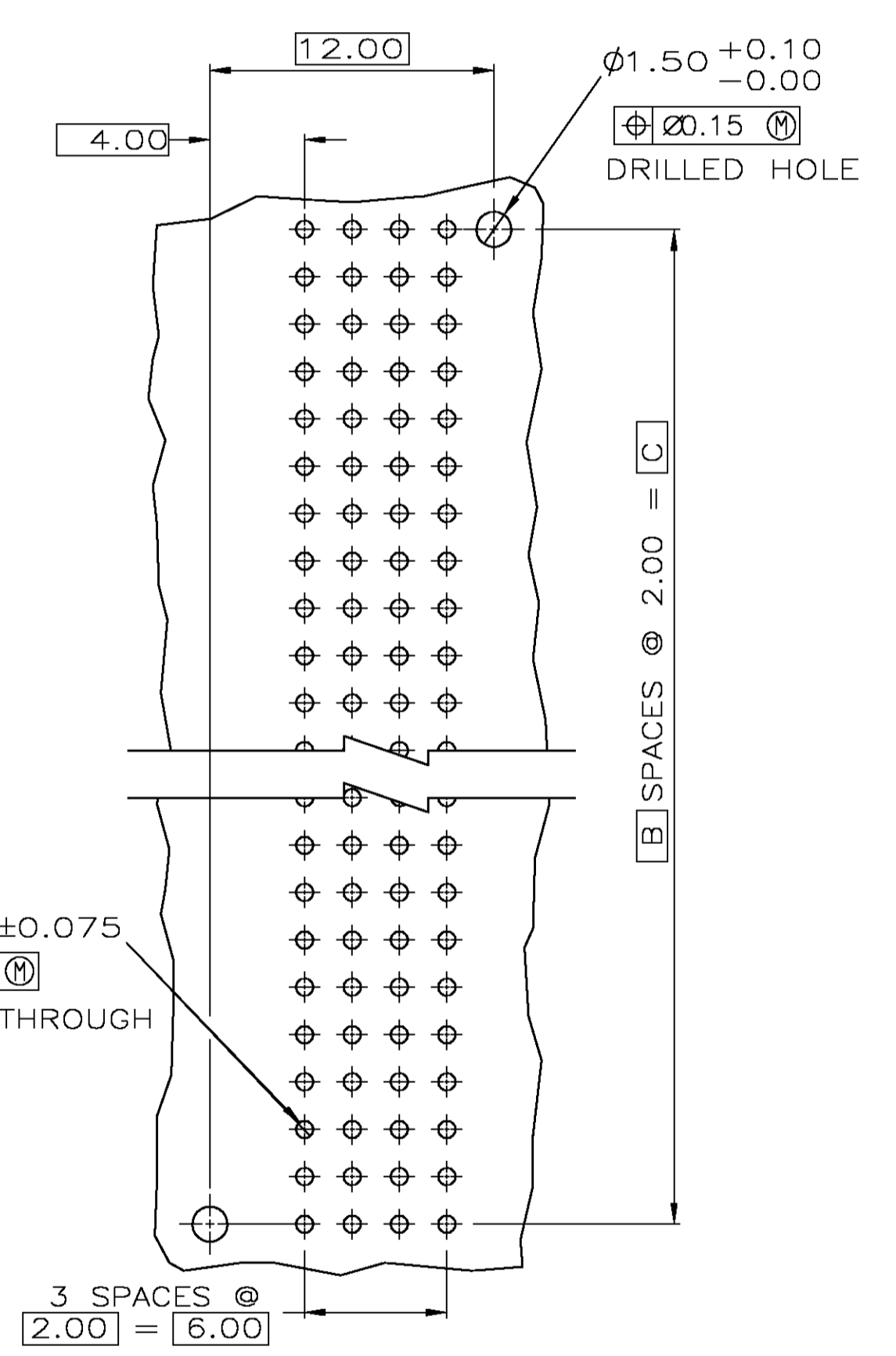
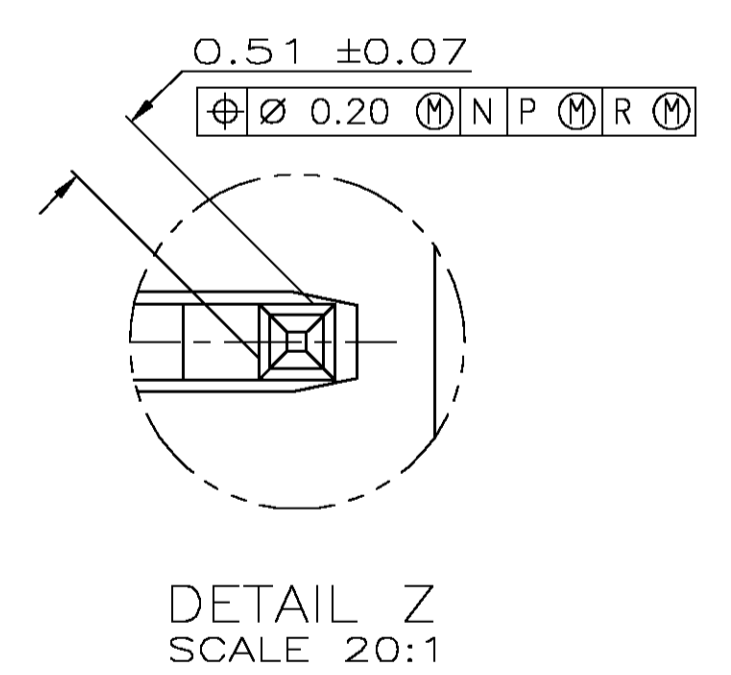
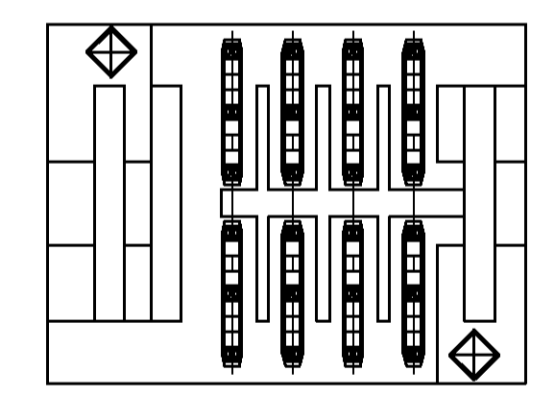
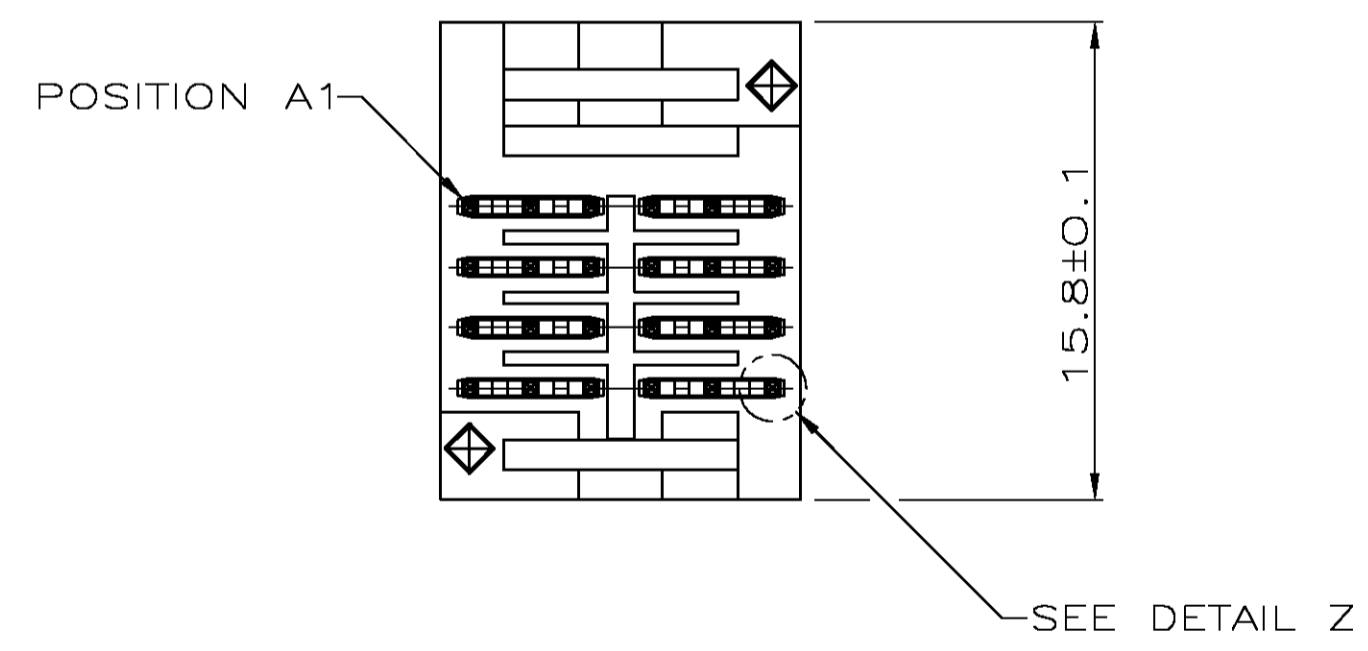
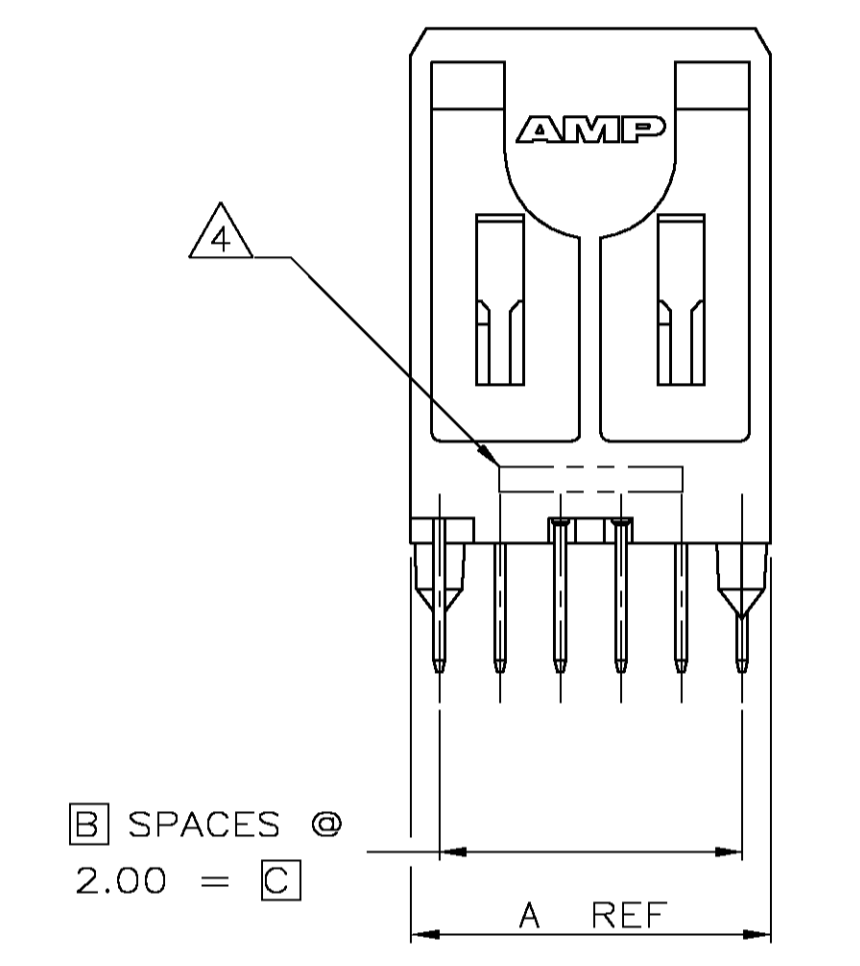
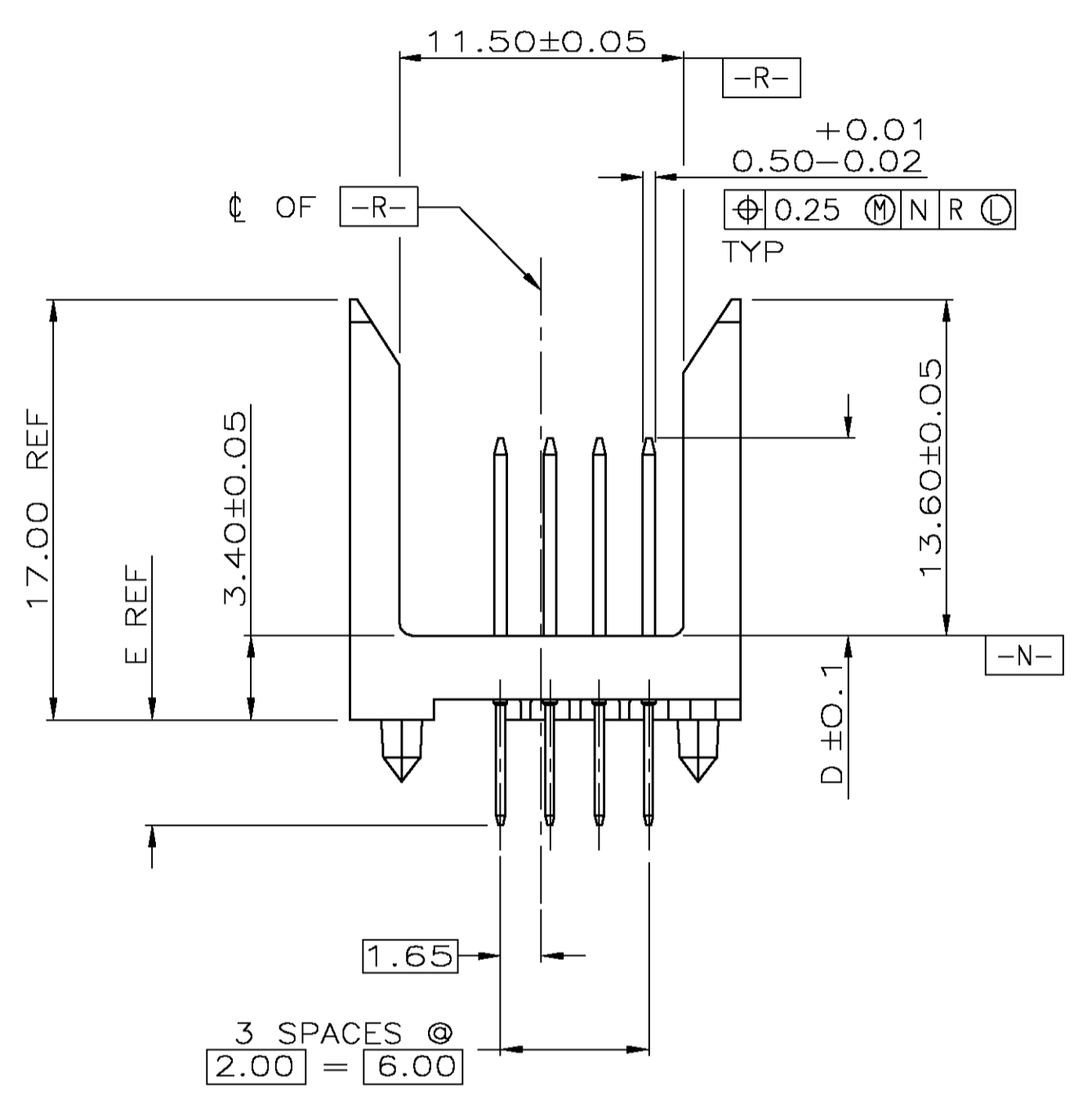
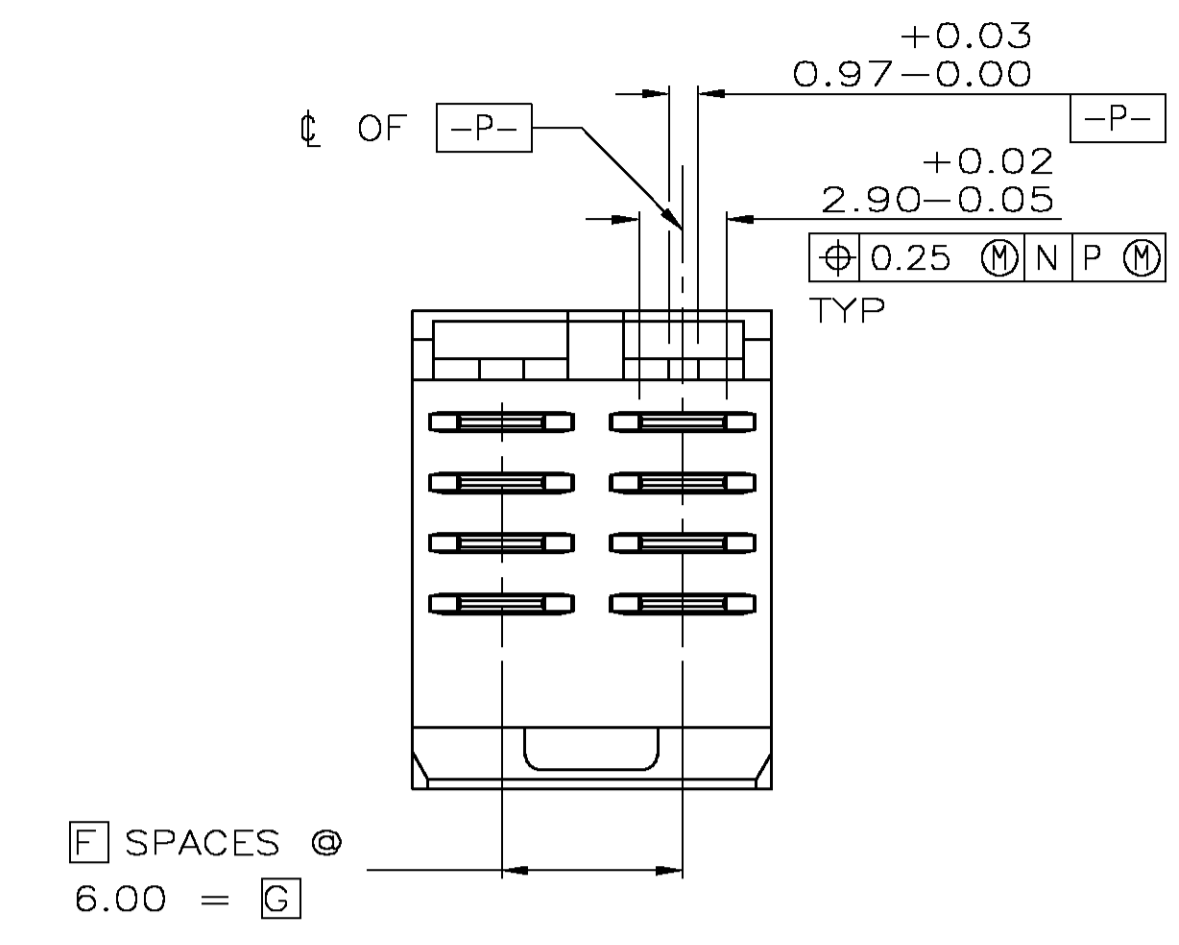

RECOMMENDED CIRCUIT PATTERN
 PER IPC-D300 TYPE II, CLASS C
 (COMPONENT SIDE)

- 1 HOUSING MATERIAL: LIQUID CRYSTAL POLYMER
 COLOR: NATURAL.
- 2 CONTACT MATERIAL: PHOSPHOR BRONZE PER UNS ALLOY NO. C51100, TEMPER: H04.
- 3 CONTACT FINISH:(E)
 UNDERPLATE (ENTIRE CONTACT):
 0.00127 MIN NICKEL PER SAE-AMS-QQ-N-290
 ON MATING SURFACES:
 FLASH GOLD PER ASTM B 488, OVER
 0.00076 MIN PALLADIUM-NICKEL OVER UNDERPLATE, OR
 0.00076 MIN GOLD PER ASTM B 488 OVER UNDERPLATE.
 ON LEADS:
 0.00381 MIN MATTE TIN PER ASTM B 545 OVER UNDERPLATE.
 LUBRICATION (MIN MATING SURFACES):
 SURFACE CONDITIONER AFTER PLATING.
- 4 PART MARKING LOCATED APPROXIMATELY AS SHOWN.

6.00	1	4.25	8.00	10.00	5	11.88	3	8	5536623-1
G	F	E	D	C	B	A	FINISH	NO OF POSN	PART NUMBER

THIS DRAWING IS A CONTROLLED DOCUMENT.		DIN R BUCHHEISTER 16/JUN/95	Tyco Electronics Corporation Harrisburg, Pa 17105-3608
DIMENSIONS: mm [INCHES]		CHK D.R. BAECHTLE 16/JUN/95	
TOLERANCES UNLESS OTHERWISE SPECIFIED:		APPRO D.R. BAECHTLE 16/JUN/95	NAME
0 PLC	± -	PRODUCT SPEC	ASSEMBLY, PIN, POWER, VERTICAL, 4 ROW, Z-PACK 2mm FB, SOLDER LEAD
1 PLC	± -	APPLICATION SPEC	
2 PLC	± 0.13	SIZE	A1
3 PLC	± -	WEIGHT	00779
4 PLC	± -	CAGE CODE	5536623
ANGLES	± -	DRAWING NO	5536623
FINISH		RESTRICTED TO	
1	2	CUSTOMER DRAWING	SCALE 4:1 SHEET 1 OF 1 REV 0