



**1.00 mm [.039"] Male Headers, Straight, Right Angle, SMT**

**SPECIFICATIONS**

- 1 amp current rating
- UL Flammability Rating: 94V-0
- Insulator Material: Black LCP
- Contact Material: Phosphor Bronze
- Insulator Resistance: 1000 Mega OHMS Min.
- Contact Resistance: 20 Milli OHMS Max.
- Dielectric Withstanding: AC 300V
- Operating Temperature: -40°C to +125°C
- Processing Temperature: 260°C for 10 seconds Max.
- Mates with Female SFM series



**TERMINATION TYPE**

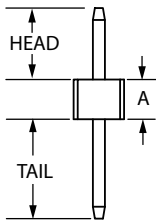

**Straight, (ST)**

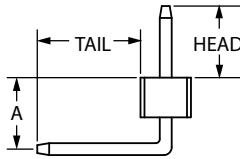

**Right Angle, (RA)**

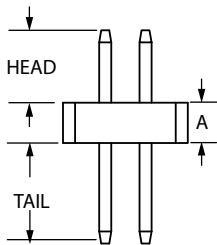

**Straight, (ST)**

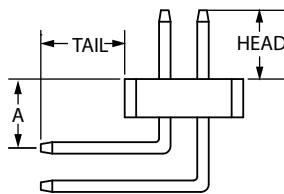

**Right Angle, (RA)**

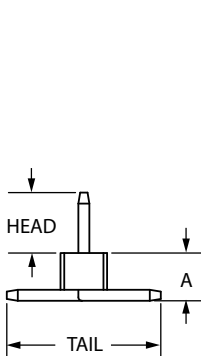

**SMT, (SC) or (SD)**

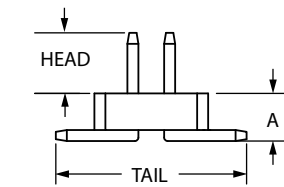

**SMT Without Guide Posts, (SM)**

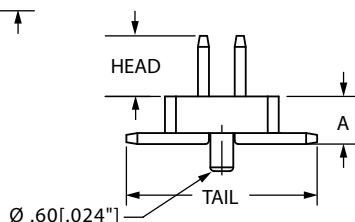

**SMT With Guide Posts, (SP)**

**SINGLE ROW**

EXAMPLE P/N	HEAD	TAIL	A
<b>STRAIGHT TERMINATION</b>			
SMH100-LPPE-S10-ST-BK	1.80 [.071"]	2.50 [.098"]	1.00 [.039"]
<b>RIGHT ANGLE TERMINATION</b>			
SMH100-LPPE-S10-RA-BK	1.80 [.071"]	2.60 [.102"]	1.80 [.071"]

**DUAL ROW**

EXAMPLE P/N	HEAD	TAIL	A
<b>STRAIGHT TERMINATIONS</b>			
SMH100-LPPE-D10-ST-BK	1.80 [.071"]	2.50 [.098"]	1.00 [.039"]
SMH150-LPPE-D10-ST-BK	1.80 [.071"]	2.50 [.098"]	1.50 [.059"]
<b>RIGHT ANGLE TERMINATION</b>			
SMH100-LPPE-D10-RA-BK	1.80 [.071"]	2.60 [.102"]	1.80 [.071"]

**SURFACE MOUNT TERMINATIONS**

EXAMPLE P/N	HEAD	TAIL	A
<b>SINGLE ROW</b>			
SMH100-LPPE-S10-SC-BK	1.65 [.065"]	4.20 [.165"]	1.30 [.051"]
SMH100-LPPE-S10-SD-BK	1.65 [.065"]	4.20 [.165"]	1.30 [.051"]
<b>DUAL ROW</b>			
SMH101-LPPE-D10-SM-BK	1.65 [.065"]	5.20 [.205"]	1.30 [.051"]
SMH101-LPPE-D10-SP-BK	1.65 [.065"]	5.20 [.205"]	1.30 [.051"]
SMH102-LPPE-D10-SM-BK	1.90 [.075"]	5.20 [.205"]	1.30 [.051"]
SMH102-LPPE-D10-SP-BK	1.90 [.075"]	5.20 [.205"]	1.30 [.051"]
SMH151-LPPE-D10-SM-BK	1.65 [.065"]	5.20 [.205"]	1.80 [.071"]
SMH151-LPPE-D10-SP-BK	1.65 [.065"]	5.20 [.205"]	1.80 [.071"]
SMH152-LPPE-D10-SM-BK	1.90 [.075"]	5.20 [.205"]	1.80 [.071"]
SMH152-LPPE-D10-SP-BK	1.90 [.075"]	5.20 [.205"]	1.80 [.071"]



**1.00 mm [.039"] Male Headers, Straight, Right Angle, SMT**

**PART NUMBER OPTIONS**

**SMH100 - L P P E - S 10 - ST - BK**

**SERIES (See Opposite Page)**

- SMH100 = 1.00 mm [.039"] Profile, 1.80 mm [.071"] Head Height
- SMH101 = 1.00 mm [.039"] Profile, 1.65 mm [.065"] Head Height
- SMH102 = 1.00 mm [.039"] Profile, 1.90 mm [.075"] Head Height
- SMH150 = 1.50 mm [.059"] Profile, 1.80 mm [.071"] Head Height
- SMH151 = 1.50 mm [.059"] Profile, 1.65 mm [.065"] Head Height
- SMH152 = 1.50 mm [.059"] Profile, 1.90 mm [.075"] Head Height

**HOUSING MATERIAL**

L = LCP

**CONTACT MATERIAL**

P = Phosphor Bronze

**CONTACT FINISH - RoHS Compliant**

P = Gold Flash Overall

S = 10u" Gold Overall

**CONTACT CENTERS**

E = 1.00 mm [.039"]

**COLOR**

BK = Black

**TERMINATION TYPE (See Opposite Page)**

- ST = Straight (1 & 2 Row)
- RA = Right Angle (1 & 2 Row)
- SC = Surface Mount, Standard (1 Row)
- SD = Surface Mount, Opposite Bend, Applicable on Even pin Counts (1 Row)
- SM = Surface Mount without Guide Posts (2 Row)
- SP = Surface Mount with Guide Posts (2 Row)

**NUMBER OF CONTACT POSITIONS (Pins per Row)**  
02 thru 50

**NUMBER OF ROWS**

- S = Single Row
- D = Dual Row

**DIMENSIONS**

**STRAIGHT (SHOWN) & RIGHT ANGLE**

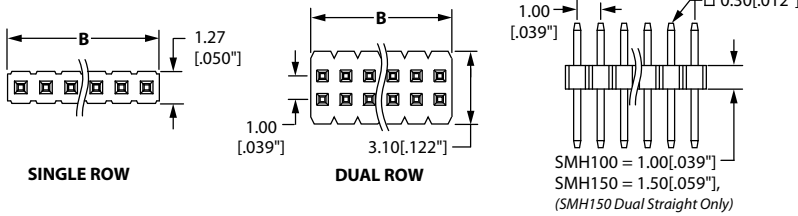

**SURFACE MOUNT, DUAL ROW**

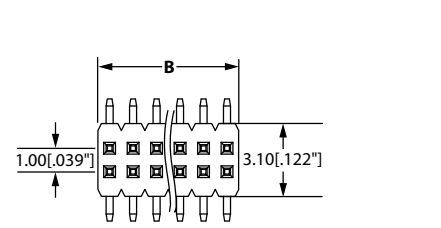

**SURFACE MOUNT, SINGLE ROW**

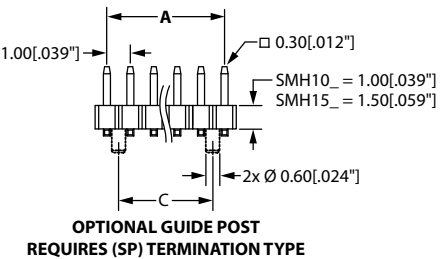
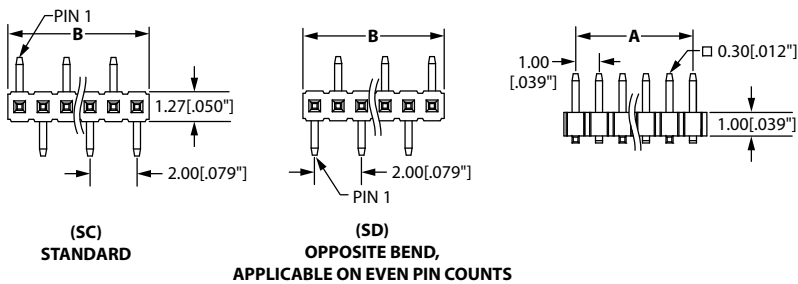

Positions	Number of Contacts Single/Dual	DIMENSION A		DIMENSION B		DIMENSION C		Positions	Number of Contacts Single/Dual	DIMENSION A		DIMENSION B		DIMENSION C	
		mm	[Inches]	mm	[Inches]	mm	[Inches]			mm	[Inches]	mm	[Inches]	mm	[Inches]
02*	02/04	1.00	0.039	2.00	0.079	N/A	N/A	26	26/52	25.00	0.984	26.00	1.024	24.00	0.945
03	03/06	2.00	0.079	3.00	0.118	1.00	0.039	27	27/54	26.00	1.024	27.00	1.063	25.00	0.984
04	04/08	3.00	0.118	4.00	0.157	2.00	0.079	28	28/56	27.00	1.063	28.00	1.102	26.00	1.024
05	05/10	4.00	0.157	5.00	0.197	3.00	0.118	29	29/58	28.00	1.102	29.00	1.142	27.00	1.063
06	06/12	5.00	0.197	6.00	0.236	4.00	0.157	30	30/60	29.00	1.142	30.00	1.181	28.00	1.102
07	07/14	6.00	0.236	7.00	0.276	5.00	0.197	31	31/62	30.00	1.181	31.00	1.220	29.00	1.142
08	08/16	7.00	0.276	8.00	0.315	6.00	0.236	32	32/64	31.00	1.220	32.00	1.260	30.00	1.181
09	09/18	8.00	0.315	9.00	0.354	7.00	0.276	33	33/66	32.00	1.260	33.00	1.299	31.00	1.220
10	10/20	9.00	0.354	10.00	0.394	8.00	0.315	34	34/68	33.00	1.299	34.00	1.339	32.00	1.260
11	11/22	10.00	0.394	11.00	0.433	9.00	0.354	35	35/70	34.00	1.339	35.00	1.378	33.00	1.299
12	12/24	11.00	0.433	12.00	0.472	10.00	0.394	36	36/72	35.00	1.378	36.00	1.417	34.00	1.339
13	13/26	12.00	0.472	13.00	0.512	11.00	0.433	37	37/74	36.00	1.417	37.00	1.457	35.00	1.378
14	14/28	13.00	0.512	14.00	0.551	12.00	0.472	38	38/76	37.00	1.457	38.00	1.496	36.00	1.417
15	15/30	14.00	0.551	15.00	0.591	13.00	0.512	39	39/78	38.00	1.496	39.00	1.535	37.00	1.457
16	16/32	15.00	0.591	16.00	0.630	14.00	0.551	40	40/80	39.00	1.535	40.00	1.575	38.00	1.496
17	17/34	16.00	0.630	17.00	0.669	15.00	0.591	41	41/82	40.00	1.575	41.00	1.614	39.00	1.535
18	18/36	17.00	0.669	18.00	0.709	16.00	0.630	42	42/84	41.00	1.614	42.00	1.654	40.00	1.575
19	19/38	18.00	0.709	19.00	0.748	17.00	0.669	43	43/86	42.00	1.654	43.00	1.693	41.00	1.614
20	20/40	19.00	0.748	20.00	0.787	18.00	0.709	44	44/88	43.00	1.693	44.00	1.732	42.00	1.654
21	21/42	20.00	0.787	21.00	0.827	19.00	0.748	45	45/90	44.00	1.732	45.00	1.772	43.00	1.693
22	22/44	21.00	0.827	22.00	0.866	20.00	0.787	46	46/92	45.00	1.772	46.00	1.811	44.00	1.732
23	23/46	22.00	0.866	23.00	0.906	21.00	0.827	47	47/94	46.00	1.811	47.00	1.850	45.00	1.772
24	24/48	23.00	0.906	24.00	0.945	22.00	0.866	48	48/96	47.00	1.850	48.00	1.890	46.00	1.811
25	25/50	24.00	0.945	25.00	0.984	23.00	0.906	49	49/98	48.00	1.890	49.00	1.929	47.00	1.850
								50	50/100	49.00	1.929	50.00	1.969	48.00	1.890

\* Position 2 not available with Guide posts.